

2343 EGLINTON AVENUE WEST

2343 Eglinton Avenue West
TORONTO, ON M6E 2L6

A PROJECT OF
BOUSFIELDS INC.
3 CHURCH ST, SUITE 200
TORONTO, ON M5E 1M2

LANDSCAPE ARCHITECT

STUDIO **tla**

20 Champlain Boulevard, Suite 102
Toronto, ON M3H 2Z1

(416) 638-4911
info@studiotla.ca
www.studiotla.ca

CONSULTANTS

RAW DESIGN INC.
317 Adelaide St W #405
Toronto, ON M5V 1P9
TEL: 416.599.9729

BOUSFIELDS INC.
3 Church Street, Suite 200
Toronto, ON M5E 1M2
TEL: 416.947.9744

COUNTERPOINT ENGINEERING
8395 Jane Street, Suite 100
Vaughan, ON L4K 5Y2
TEL: 905.326.1404

STAMP



REVISIONS

- | | |
|---|---------------------------|
| 5 | |
| 4 | |
| 3 | |
| 2 | |
| 1 | 2025-03-17 ZBA SUBMISSION |

PHASE
ZBA PHASE

PROJECT NUMBER
PROJECT 23-166

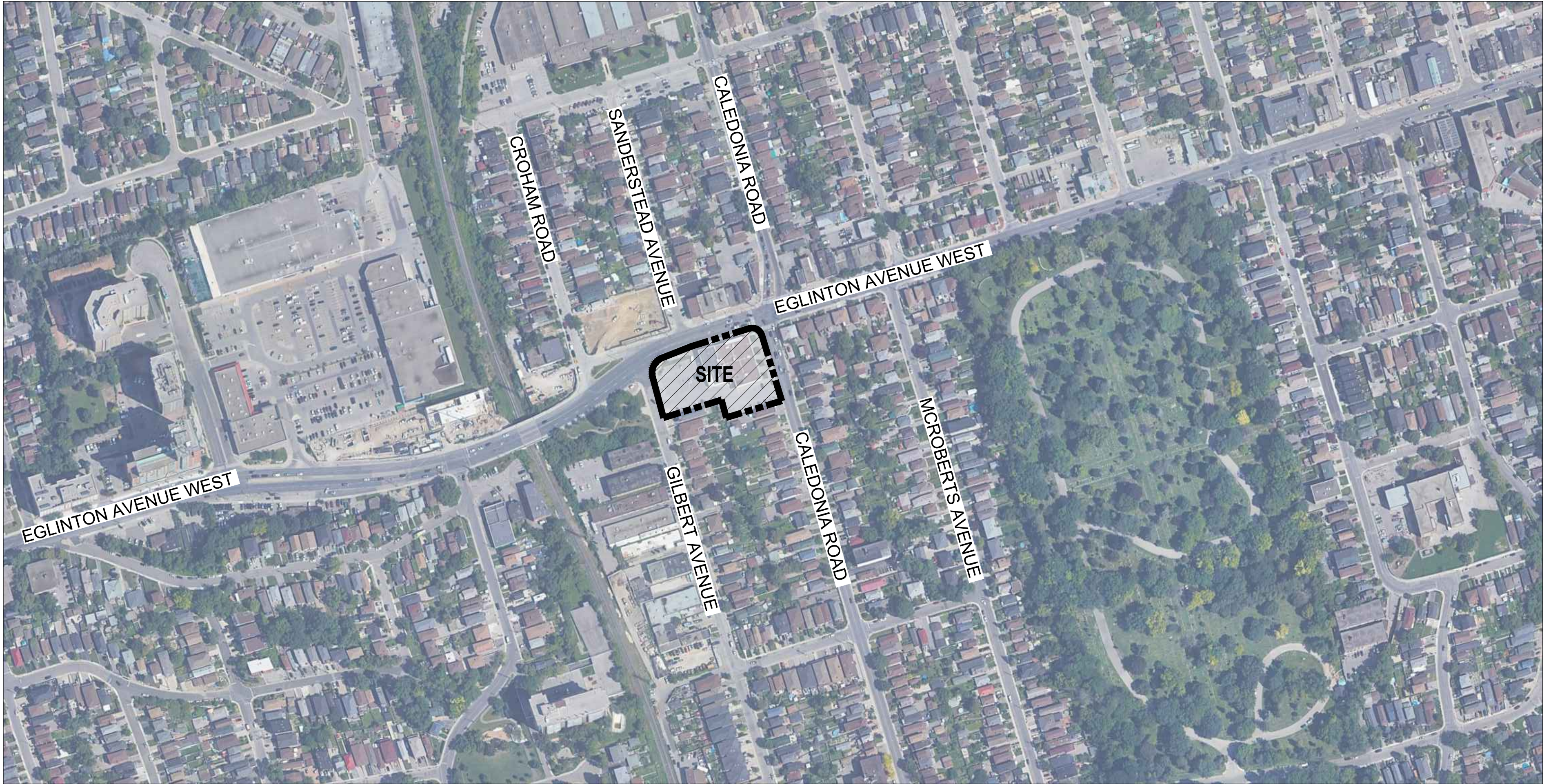

Sheet List Table

Sheet Number	Sheet Title
LC.000	COVER SHEET
LS.100	LANDSCAPE PLAN
LV.101	SOIL VOLUME PLAN
LU.101	COMPOSITE UTILITY PLAN
LD.100	LANDSCAPE SECTIONS
LD.101	LANDSCAPE SECTIONS
LD.200	LANDSCAPE DETAILS
LD.201	LANDSCAPE DETAILS
LD.202	LANDSCAPE DETAILS
LD.203	LANDSCAPE DETAILS
SC-1	SOIL CELL LAYOUT
SC-2	SOIL CELL SECTIONS
SC-3	SOIL CELL SECTIONS

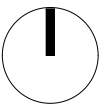

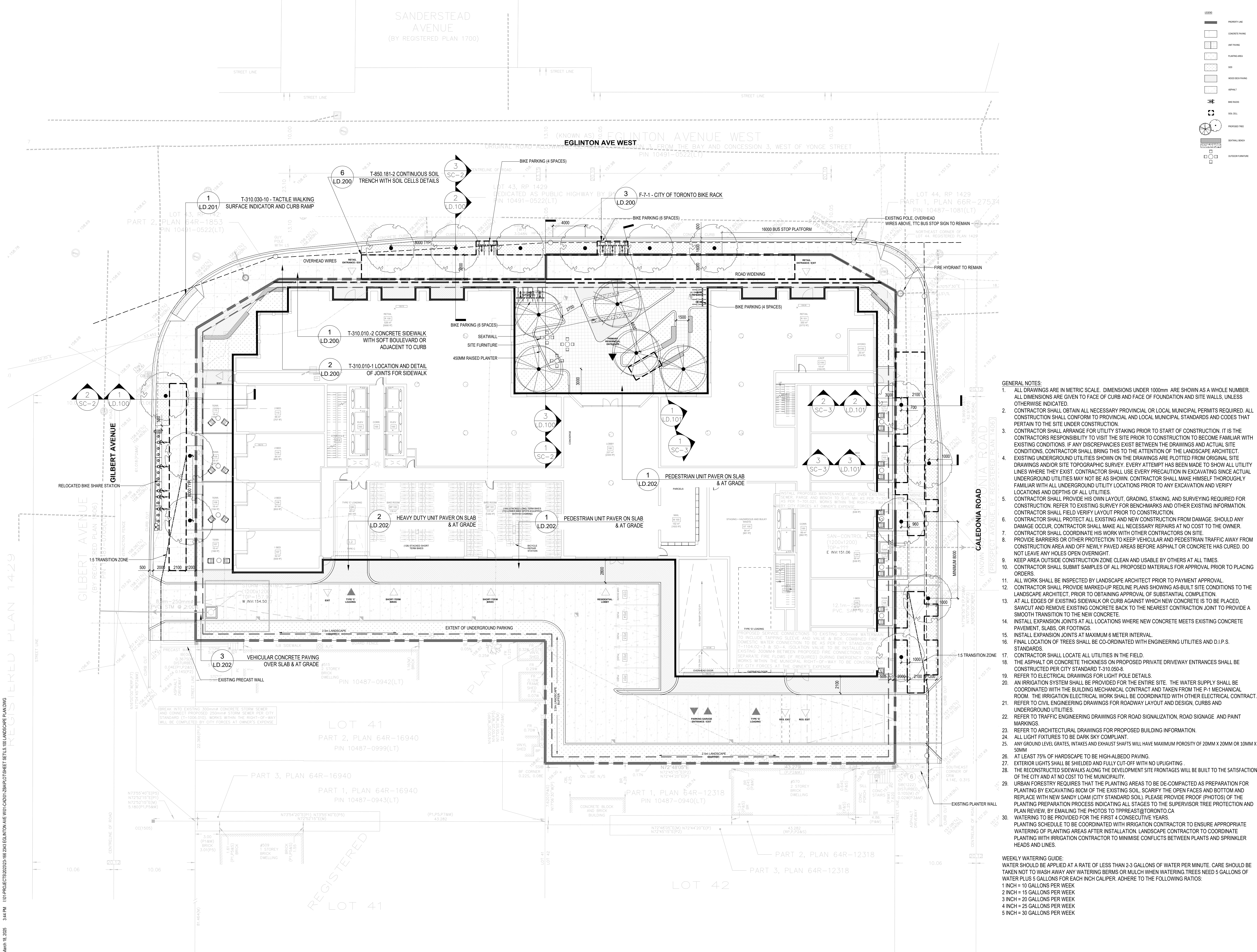

2343 Eglinton Avenue West

2343 Eglinton Avenue West
TORONTO, ON M6E 1L6

Project Number
23-166

Client
Bousfields Inc.
3 Church St, Suite 200
Toronto, ON M5E 1M2

Consultant
RAW DESIGN INC.
317 Adelaide St W #405
Toronto, ON M5V 1P9
TEL: 416.599.9729
COUNTERPOINT ENGINEERING
8395 Jane Street, Suite 100
Vaughan, ON L4K 5Y2
TEL: 905.328.1404
BOUSFIELDS INC.
3 Church Street, Suite 200
Toronto, ON M5E 1M2
TEL: 416.947.9744

Revisions

1	ISSUED FOR ZBA	2025-03-11	LTC
#	ISSUED FOR XXX	YYYY-MM-DD	BY

Stamp

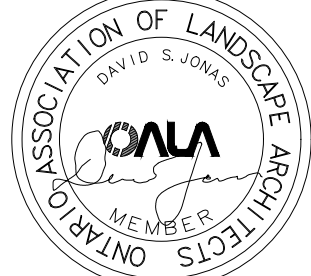

Key map

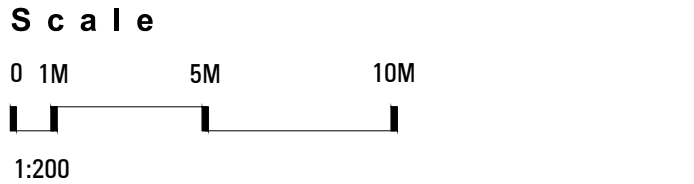
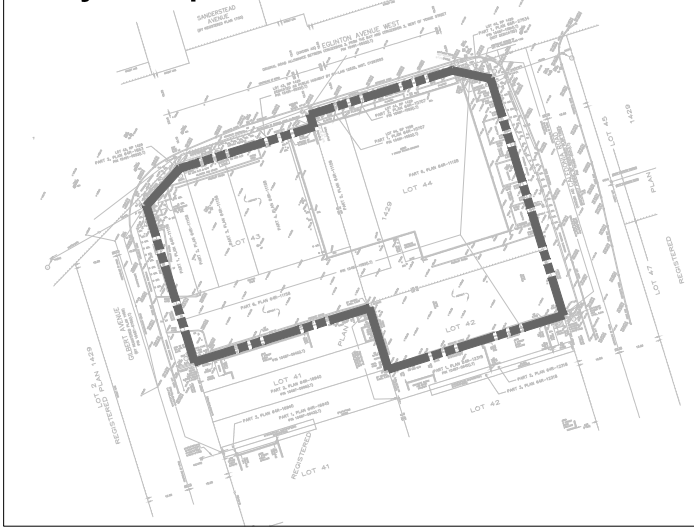

Phase
ZBA PHASE

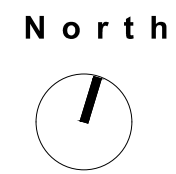

Drawing Name

LANDSCAPE PLAN

Sheet Number
NOT FOR CONSTRUCTION

LS.100

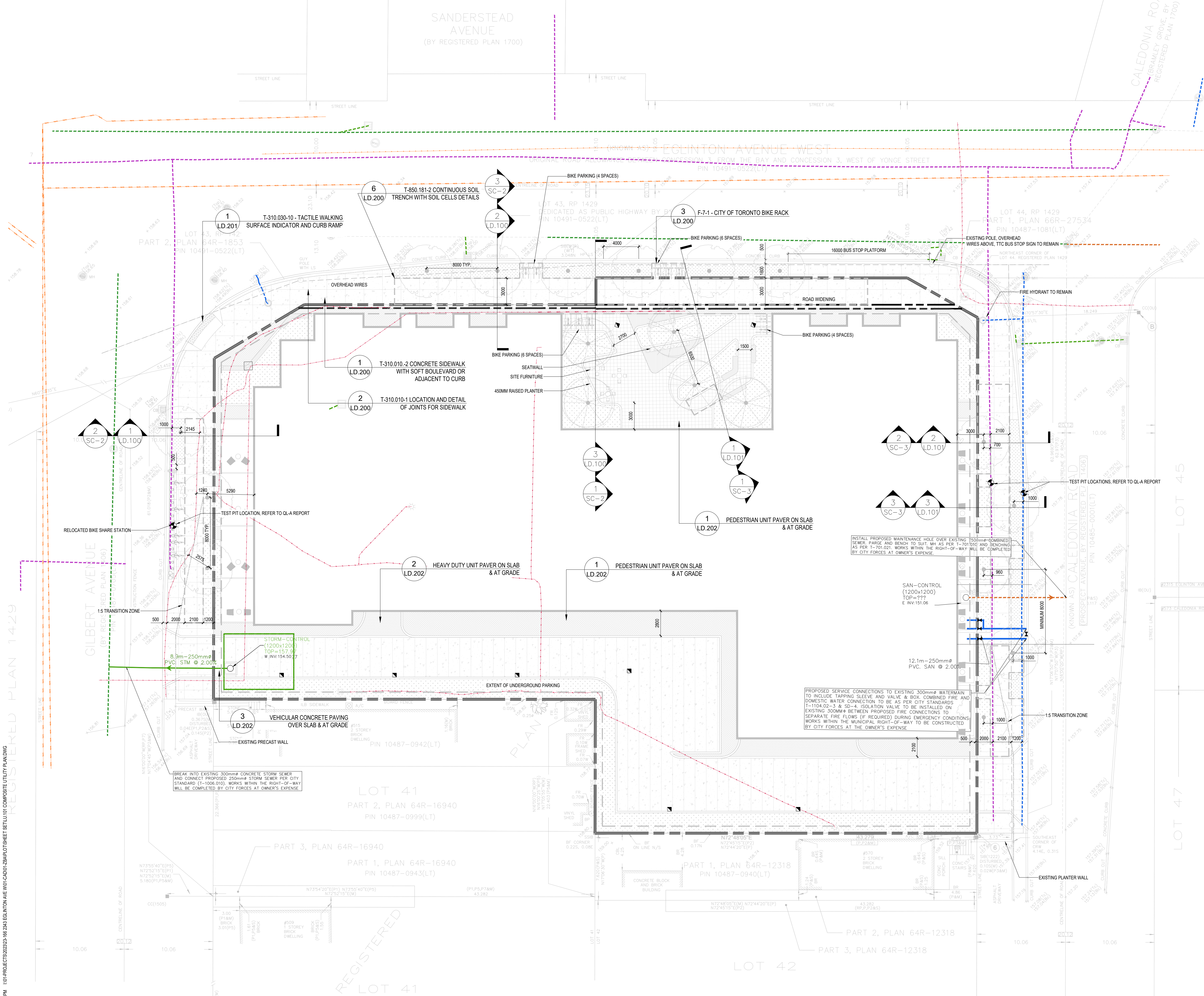

GENERAL NOTES:
1. UTILITY AND SERVICE CONFIRMED BY QLA INVESTIGATION.
2. ALL UTILITY AND SERVICING REFER TO CIVIL ENGINEER PLANS.

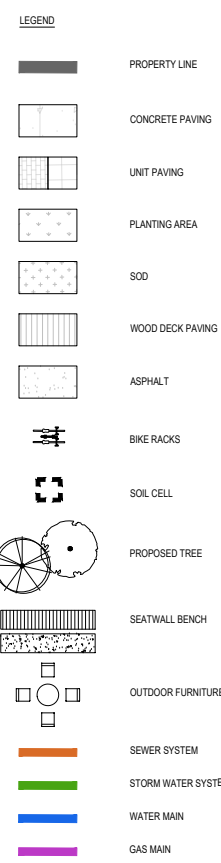

Landscape Architect

STUDIO tla

20 Champlain Blvd, Suite 102 - Toronto ON - M3H 2Z1
(416) 638-4911 - info@studiotla.ca - studiotla.ca

2343 Eglinton Avenue West

2343 Eglinton Avenue West
TORONTO, ON M6E 2L6

Project Number
23-166

Client

Bousfields Inc.
3 Church St, Suite 200
Toronto, ON M5E 1M2

Consultant

RAW DESIGN INC.
317 Adelaide St W #405
Toronto, ON M5V 1P9
TEL: 416.599.9729

COUNTERPOINT ENGINEERING
8395 Jane Street, Suite 100
Vaughan, ON L4K 5Y2
TEL: 905.328.1404

BOUSFIELDS INC.
3 Church Street, Suite 200
Toronto, ON M5E 1M2
TEL: 416.947.9744

Revisions

1	ISSUED FOR ZBA	2025-03-11	LTC
#	ISSUED FOR XXX	YYYY-MM-DD	BY

Stamp

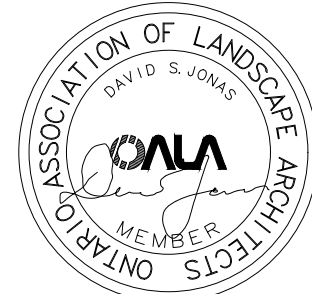

Key map

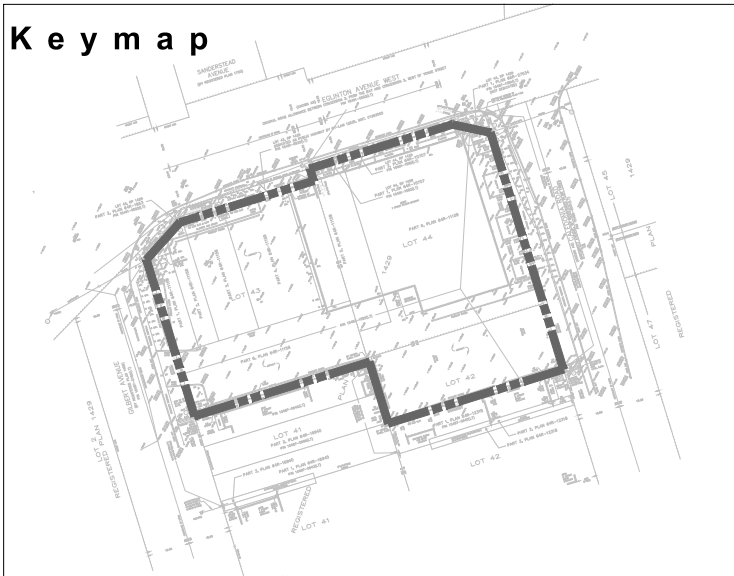

Scale

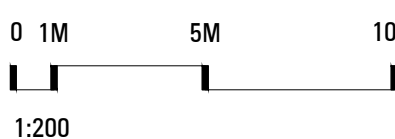

Phase
ZBA PHASE

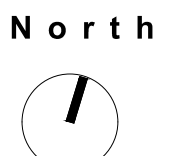

Drawing Name

COMPOSITE UTILITY PLAN

Sheet Number

NOT FOR CONSTRUCTION

LU.101

© STUDIO tla

2343 Eglinton Avenue West
TORONTO, ON M6E 2L6

Client

Bousfields Inc.
3 Church St, Suite 200
Toronto, ON M5E 1M2

Consultant

RAW DESIGN INC.
317 Adelaide St W #405
Toronto, ON M5V 1P9
TEL: 416.599.9729

COUNTERPOINT ENGINEERING
8395 Jane Street, Suite 100
Vaughan, ON L4K 5Y2
TEL: 905.326.1404

BOUSFIELDS INC.
3 Church Street, Suite 200
Toronto, ON M5E 1M2
TEL: 416.947.9744

Revisions

1	ISSUED FOR ZBA	2025-03-11	LTC
#	ISSUED FOR XXX	YYYY-MM-DD	BY

S t a m p

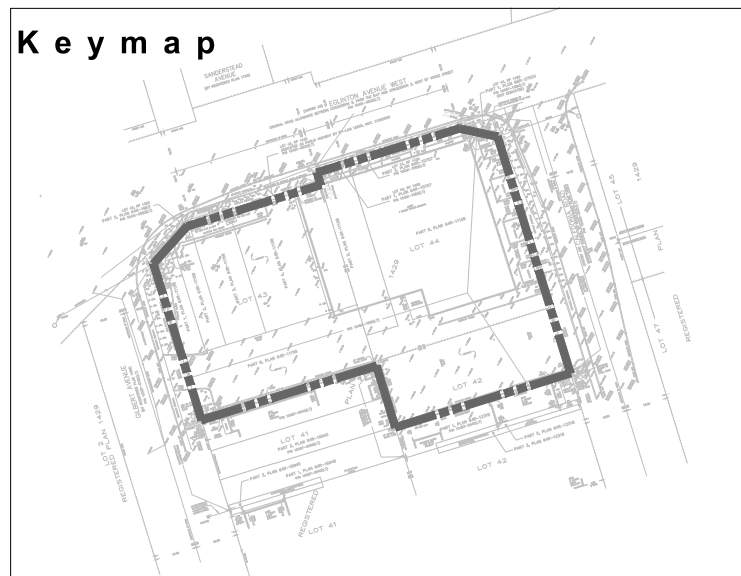

Scale

0
1
AS INDICATED

Phase

ZBA PHASE

Drawing Name

LANDSCAPE SECTIONS

Sheet Number

NOT FOR CONSTRUCTION

LD.100

© STUDIO tla

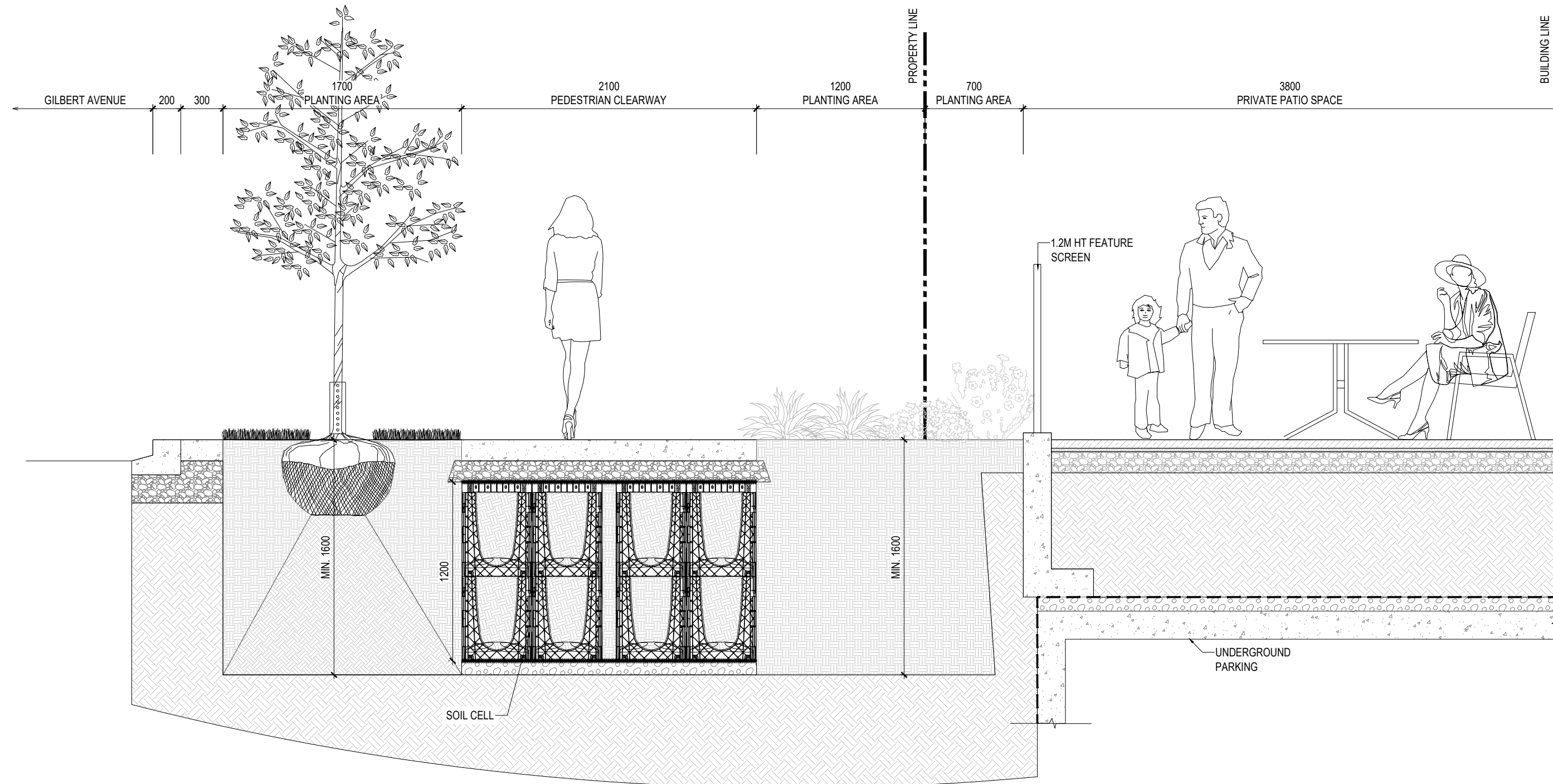

1 LANDSCAPE SECTION 1
1:30

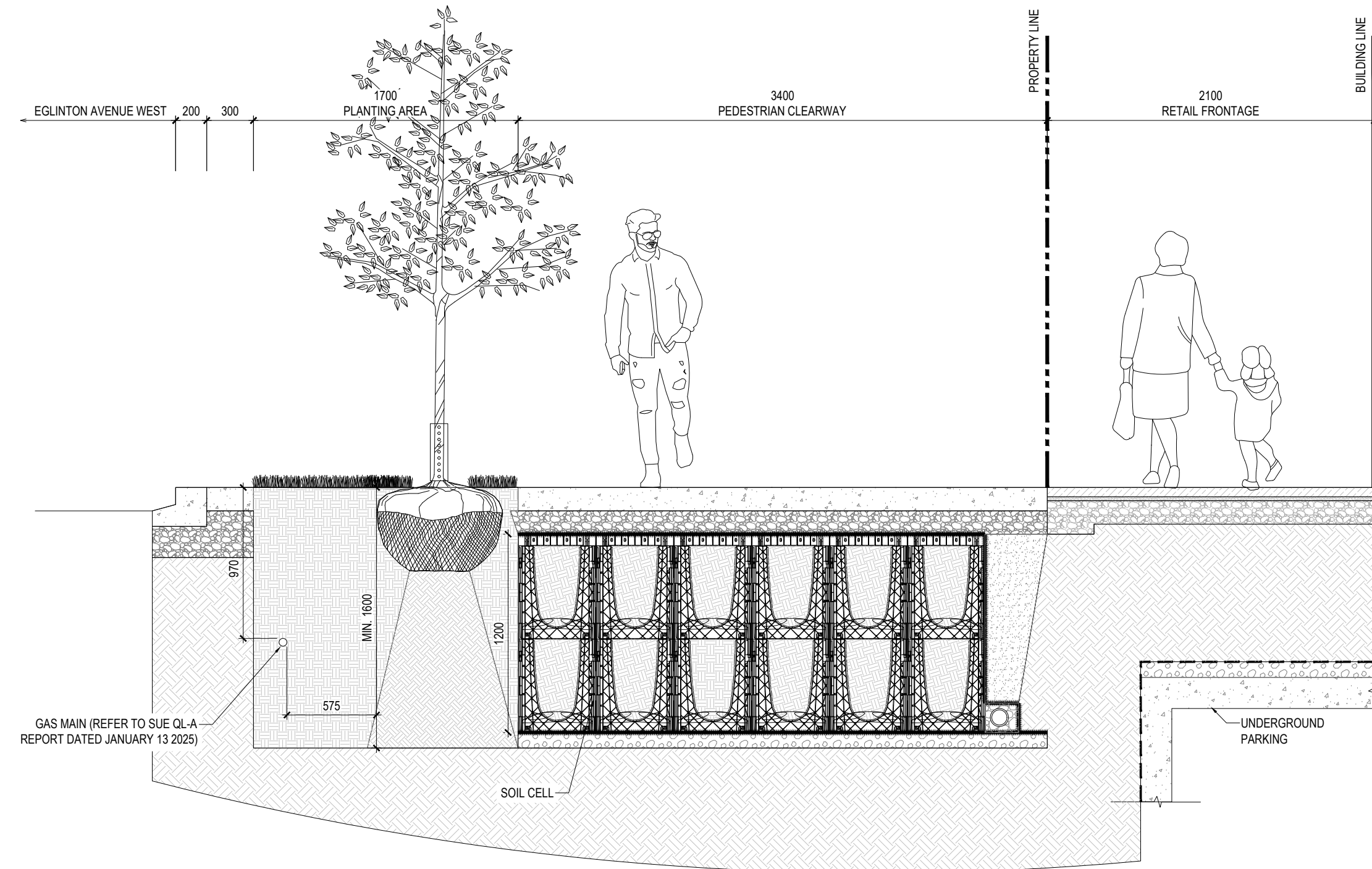

2 LANDSCAPE SECTION 2
1:30

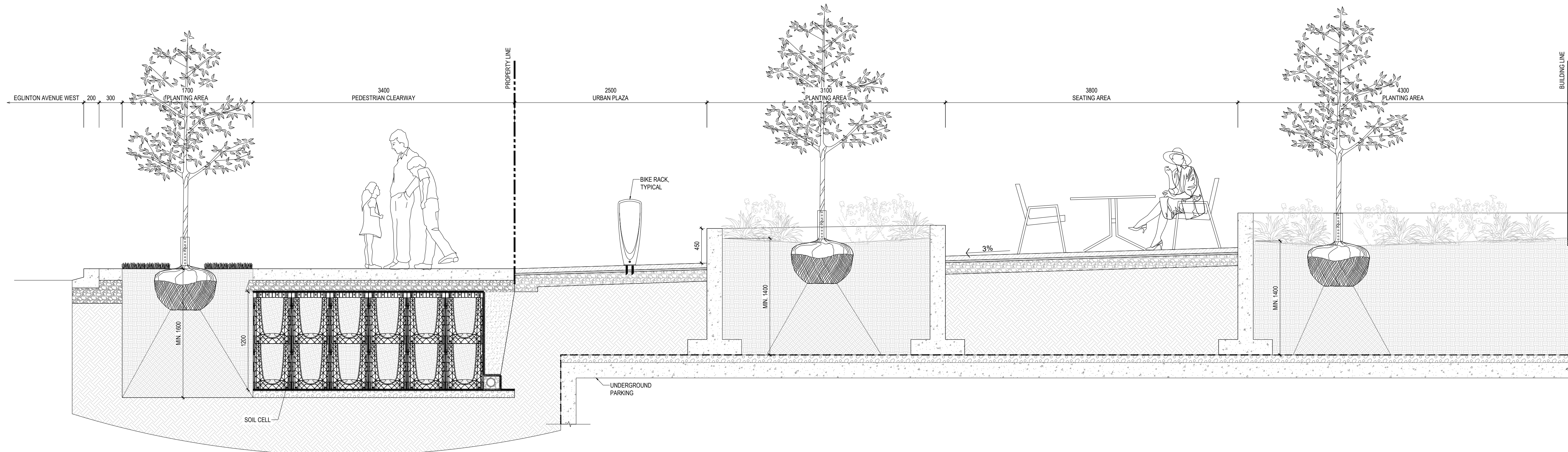

3 LANDSCAPE SECTION 3
1:30

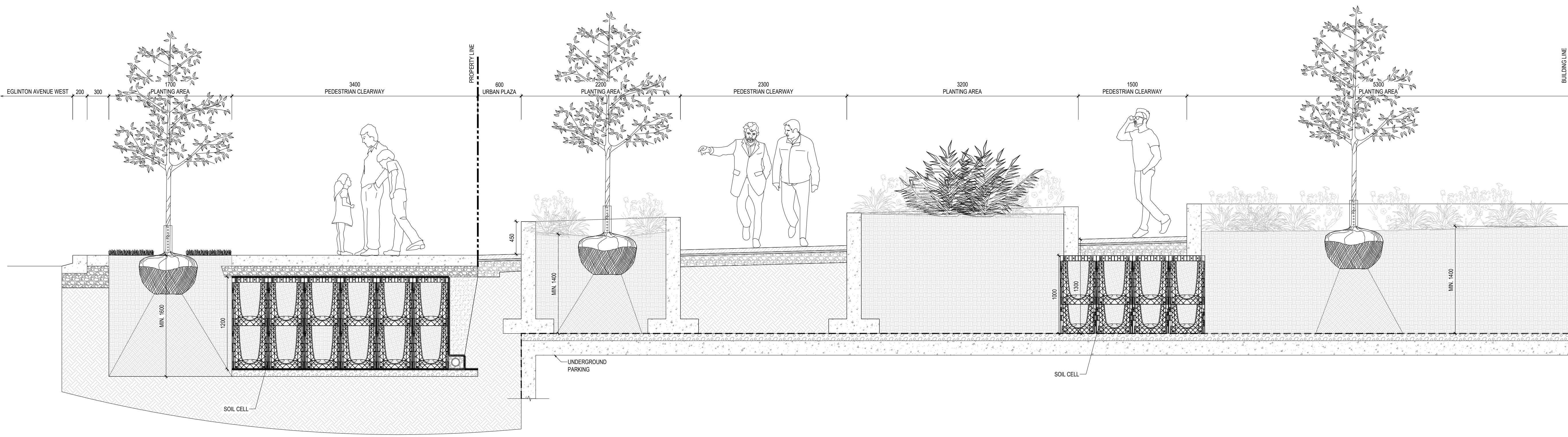

1 LANDSCAPE SECTION 4
1:30

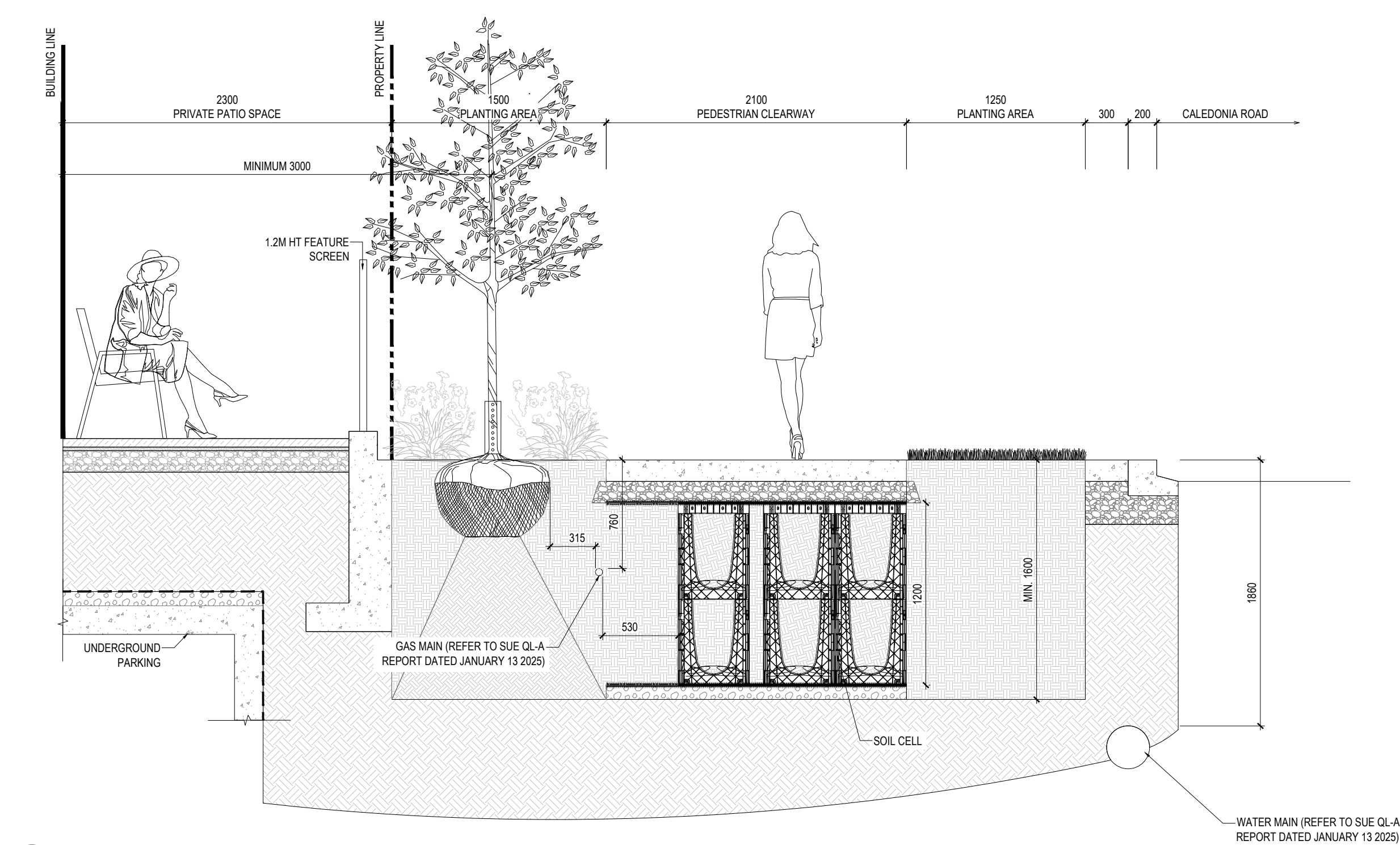

2 LANDSCAPE SECTION 5
1:30

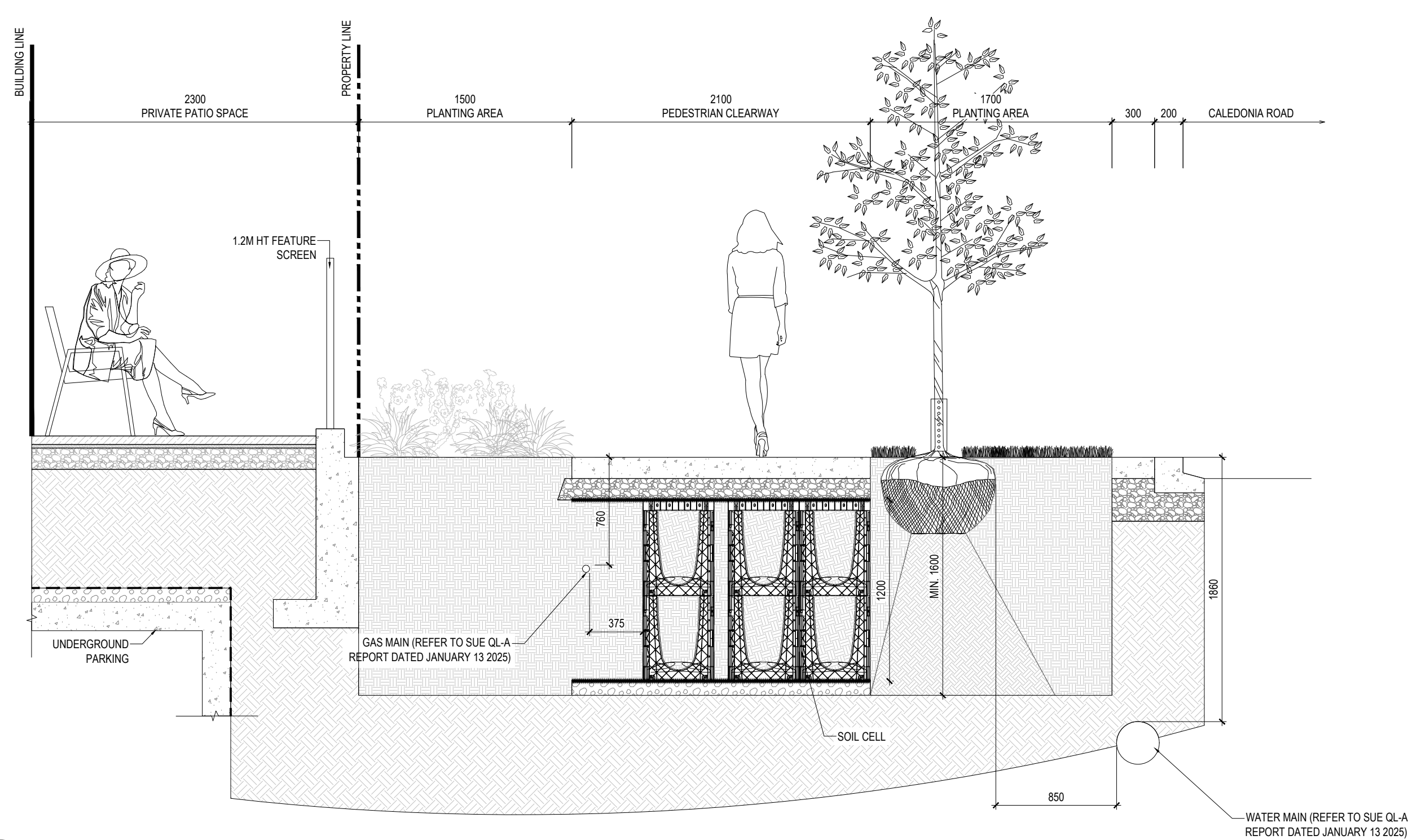

3 LANDSCAPE SECTION 6
1:30

NOTE:
THE SECTIONS ALONG CALIDONIA RD MEET THE CITY OF TORONTO STREETSCAPE MANUAL WITH A DOUBLE ALLEY OF TREES. WE ARE CURRENTLY NOT MEETING APPENDIX O FOR THE OFFSET TO THE GAS LINE (WEST ROW OF TREES). THE ALTERNATIVE IS TO REMOVE 3 STREET TREES ON THE WEST SIDE OF THE SIDEWALK. WE HAVE MAXIMIZED TREE PLANTING WITH EXISTING SERVICES AND THE SIDEWALK TAPER ON THE EAST SIDE OF THE SIDEWALK.

Landscape Architect

STUDIO tla

20 Champlain Blvd, Suite 102 - Toronto ON - M3H 2Z1
(416) 638-4911 - info@studiotla.ca - studiotla.ca

2343 Eglinton Avenue West

2343 Eglinton Avenue West
TORONTO, ON M6E 2L6

Project Number
23-166

Client
Bousfields Inc.
3 Church St, Suite 200
Toronto, ON M5E 1M2

Consultant
RAW DESIGN INC.
317 Adelaide St W #405
Toronto, ON M5V 1P9
TEL: 416.599.9729
COUNTERPOINT ENGINEERING
8395 Jane Street, Suite 100
Vaughan, ON L4K 5Y2
TEL: 905.326.1404
BOUSFIELDS INC.
3 Church Street, Suite 200
Toronto, ON M5E 1M2
TEL: 416.947.9744

Revisions

1	ISSUED FOR ZBA	2025-03-11	LTC
#	ISSUED FOR XXX	YYYY-MM-DD	BY

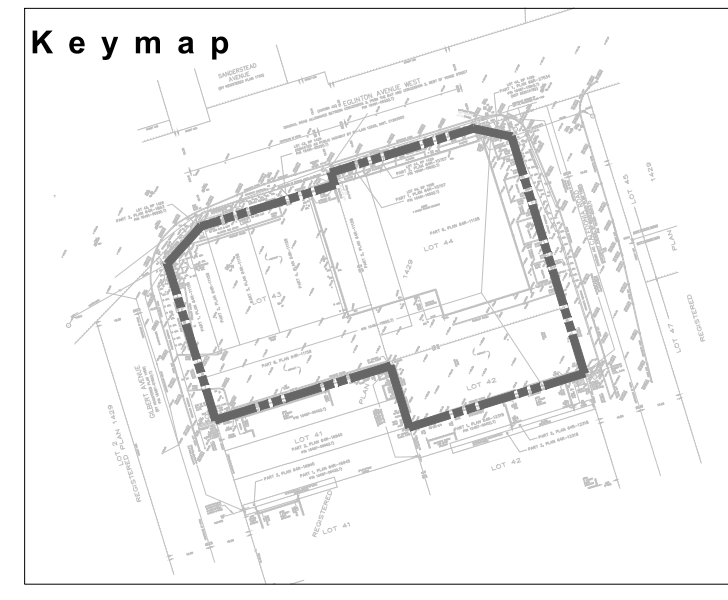

Scale
0
1
AS INDICATED
Phase
ZBA PHASE
North

Drawing Name
LANDSCAPE SECTIONS

Sheet Number
NOT FOR CONSTRUCTION

LD.101
© STUDIO tla

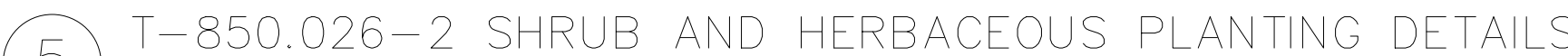

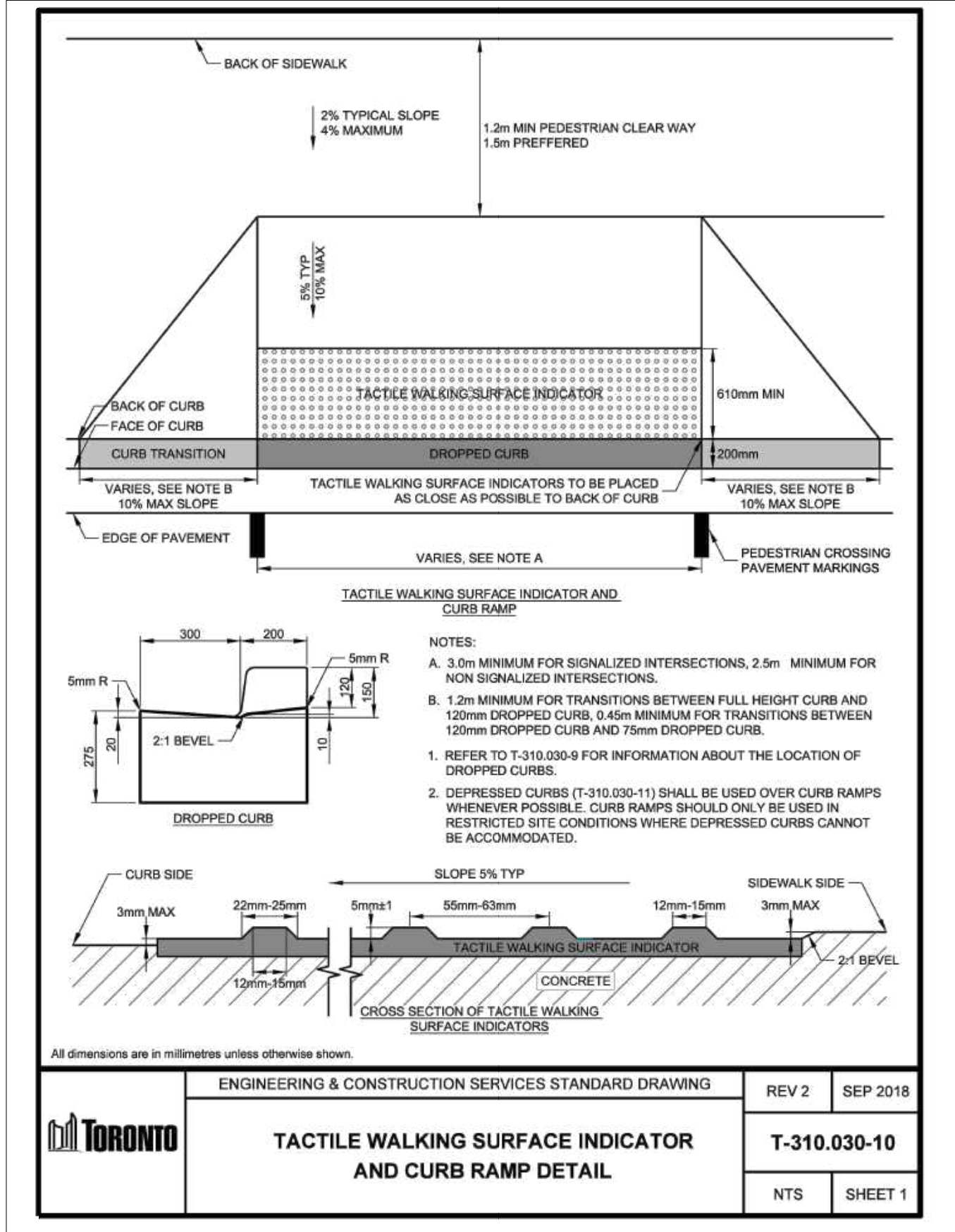

1 T-310.030-10 – TACTILE WALKING SURFACE INDICATOR AND CURB RAMP

2343 Eglinton Avenue West

2343 Eglinton Avenue West
TORONTO, ON M6E 2L6

Project Number
23-166

Client
Bousfields Inc.
3 Church St, Suite 200
Toronto, ON M5E 1M2

Consultant

RAW DESIGN INC.
317 Adelaide St W #405
Toronto, ON M5V 1P9
TEL: 416.599.9729

COUNTERPOINT ENGINEERING
8395 Jane Street, Suite 100
Vaughan, ON L4K 5Y2
TEL: 905.326.1404

BOUSFIELDS INC.
3 Church Street, Suite 200
Toronto, ON M5E 1M2
TEL: 416.947.9744

Revisions

1	ISSUED FOR ZBA	2025-03-11	LTC
#	ISSUED FOR XXX	YYYY-MM-DD	BY

Stamp

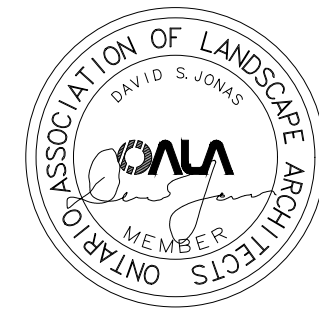

Key map

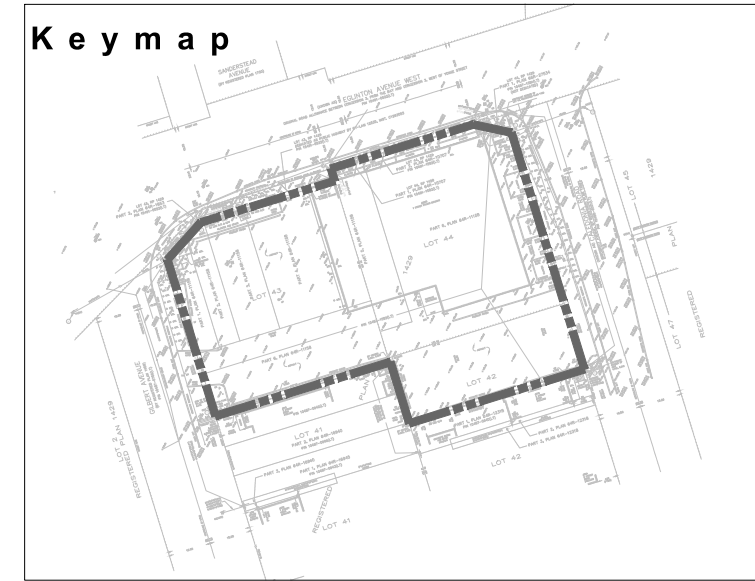

Scale

0
1
AS INDICATED

Phase

ZBA PHASE

North

Drawing Name

LANDSCAPE DETAILS

Sheet Number

NOT FOR CONSTRUCTION

LD.201

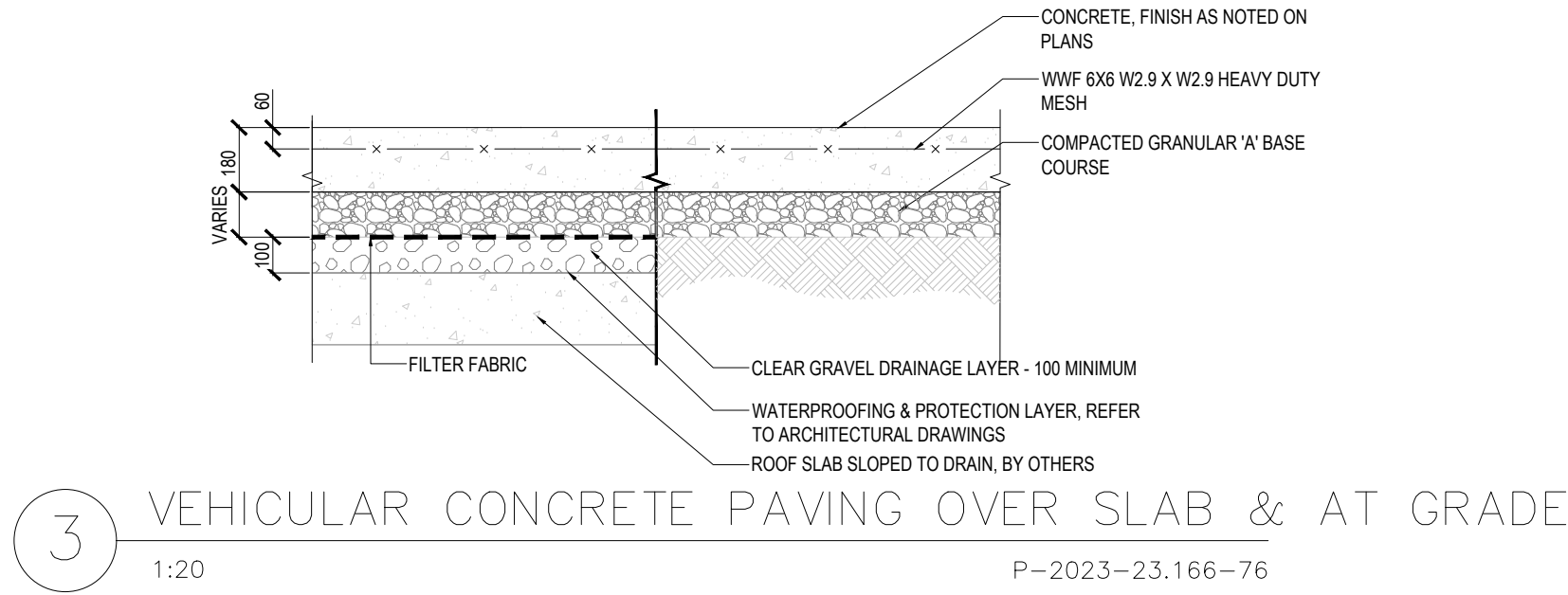
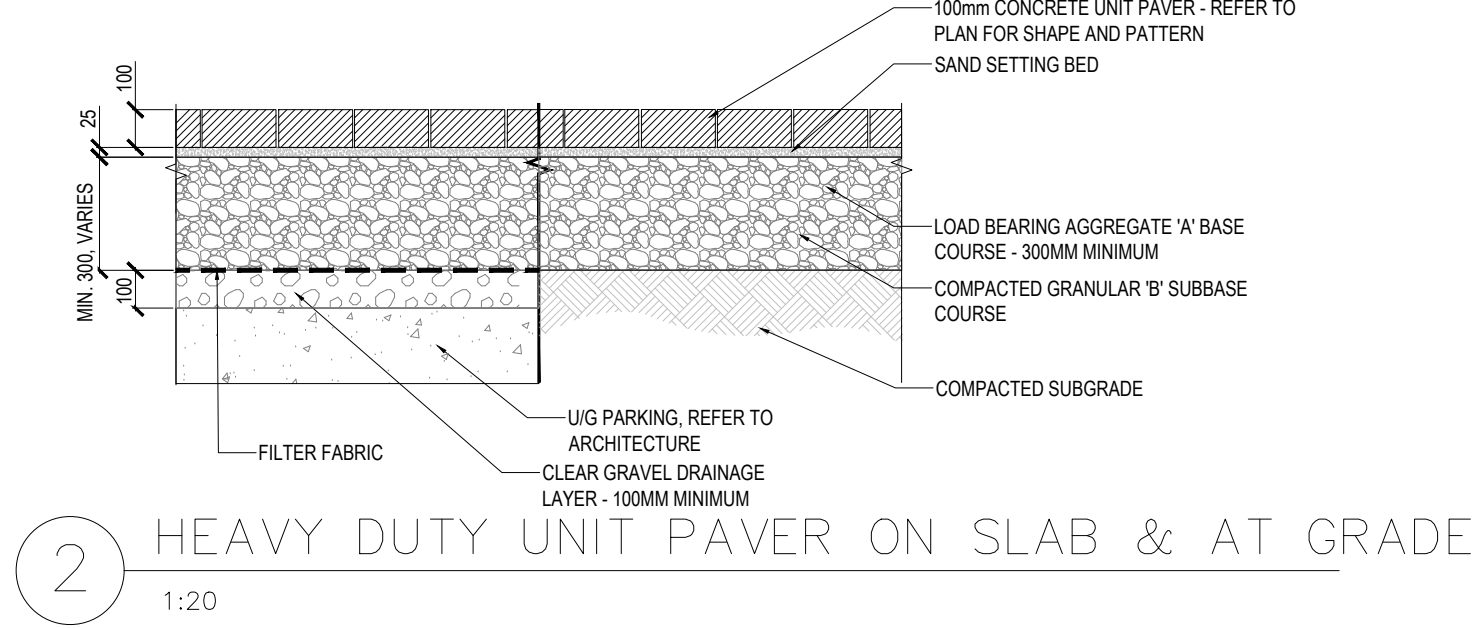
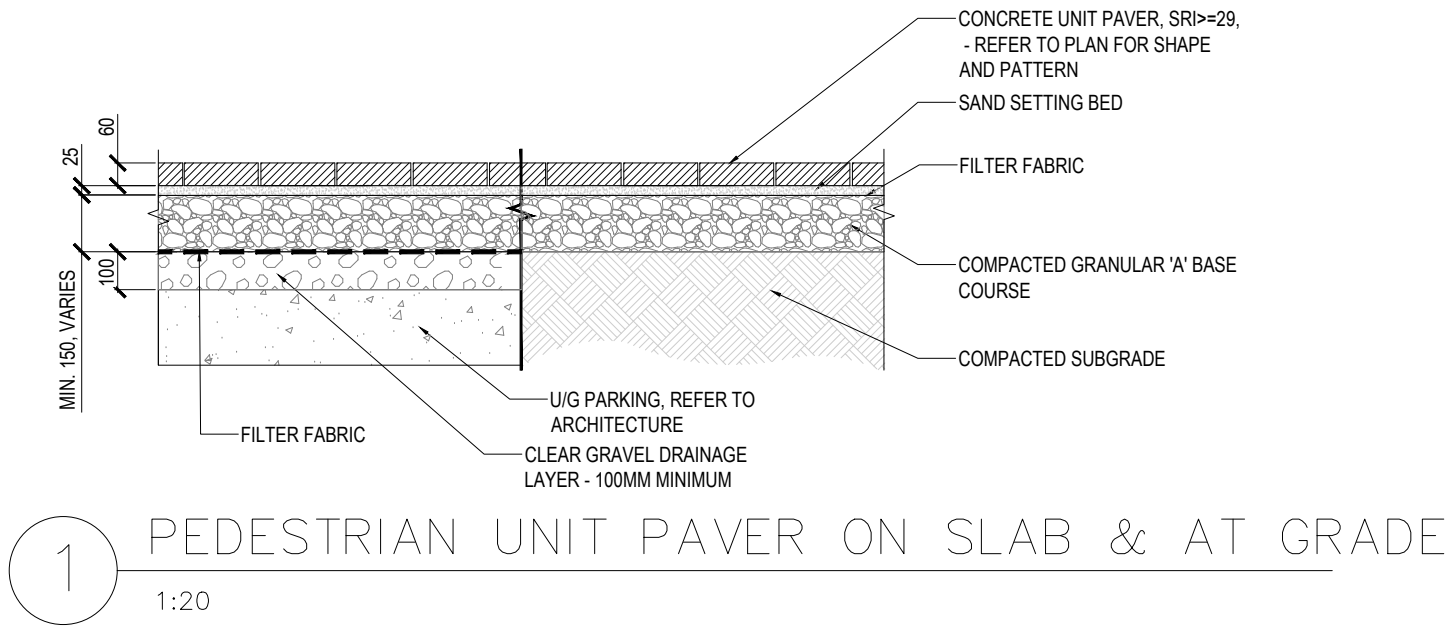

2343 Eglinton Avenue West

2343 Eglinton Avenue West
TORONTO, ON M6E 2L6

Project Number
23-166

Client
Bousfields Inc.
3 Church St, Suite 200
Toronto, ON M5E 1M2

Consultant
RAW DESIGN INC.
317 Adelaide St W #405
Toronto, ON M5V 1P9
TEL: 416.599.9729
COUNTERPOINT ENGINEERING
8395 Jane Street, Suite 100
Vaughan, ON L4K 5Y2
TEL: 905.326.1404
BOUSFIELDS INC.
3 Church Street, Suite 200
Toronto, ON M5E 1M2
TEL: 416.947.9744

Revisions

1	ISSUED FOR ZBA	2025-03-11	LTC
#	ISSUED FOR XXX	YYYY-MM-DD	BY

Stamp

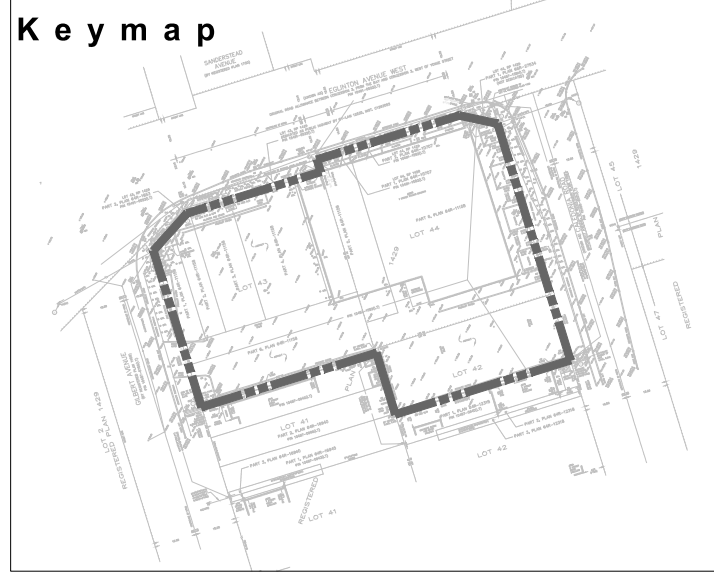
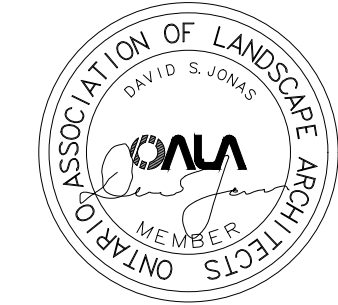

Scale
0
1
AS INDICATED
Phase
ZBA PHASE
North

Drawing Name
LANDSCAPE DETAILS

Sheet Number
NOT FOR CONSTRUCTION

LD.202

2343 Eglinton Avenue West
TORONTO, ON M6E 2L6

C l i e n t
Bousfields Inc.
3 Church St, Suite 200
Toronto, ON M5E 1M2

RAW DESIGN INC.
317 Adelaide St W #405
Toronto, ON M5V 1P9
TEL: 416.599.9729

COUNTERPOINT ENGINEERING
8395 Jane Street, Suite 100
Vaughan, ON L4K 5Y2
TEL: 905.326.1404

BOUSFIELDS INC.
3 Church Street, Suite 200
Toronto, ON M5E 1M2
TEL: 416.947.9744

<p>NOTE: THE CONTRACTOR IS TO SUPPLY TOPSOIL/FILL MATERIAL TO THE DEPTHS INDICATED ON THE CHART BELOW.</p>	
<p>TOPSOIL DEPTH CHART</p>	
LANDSCAPE AREAS	DEPTH IN mm
LAWN AREAS (SOD)	300
LAWN AREAS (SEED)	300
PLANTING BEDS - GRASSES, PERENNIALS AND GROUNDCOVER	300
PLANTING BEDS - MEDIUM AND SMALL SHRUBS	450
RAISED PLANTERS	600
SHADE AND ORNAMENTAL TREES	PER TREE INSTALLATION DETAIL

1	ISSUED FOR ZBA	2025-03-11	L
#	ISSUED FOR XXX	YYYY-MM-DD	E

Key map

0
1
AS INDICATED

North

LANDSCAPE DETAILS

NOT FOR CONSTRUCTION

LD.203

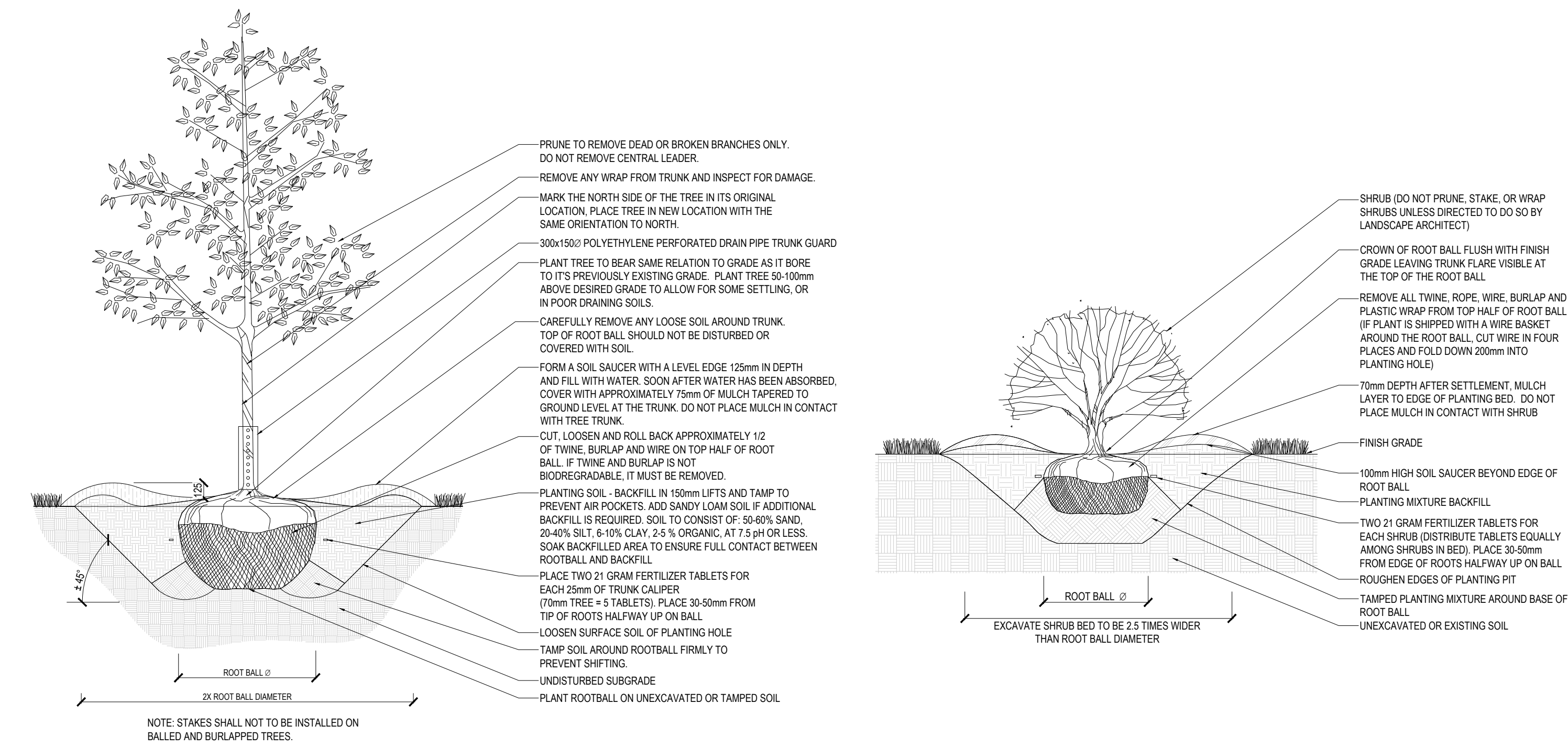

1 B&B DECIDUOUS TREE PLANTING DETAIL
SCALE = N.T.S.

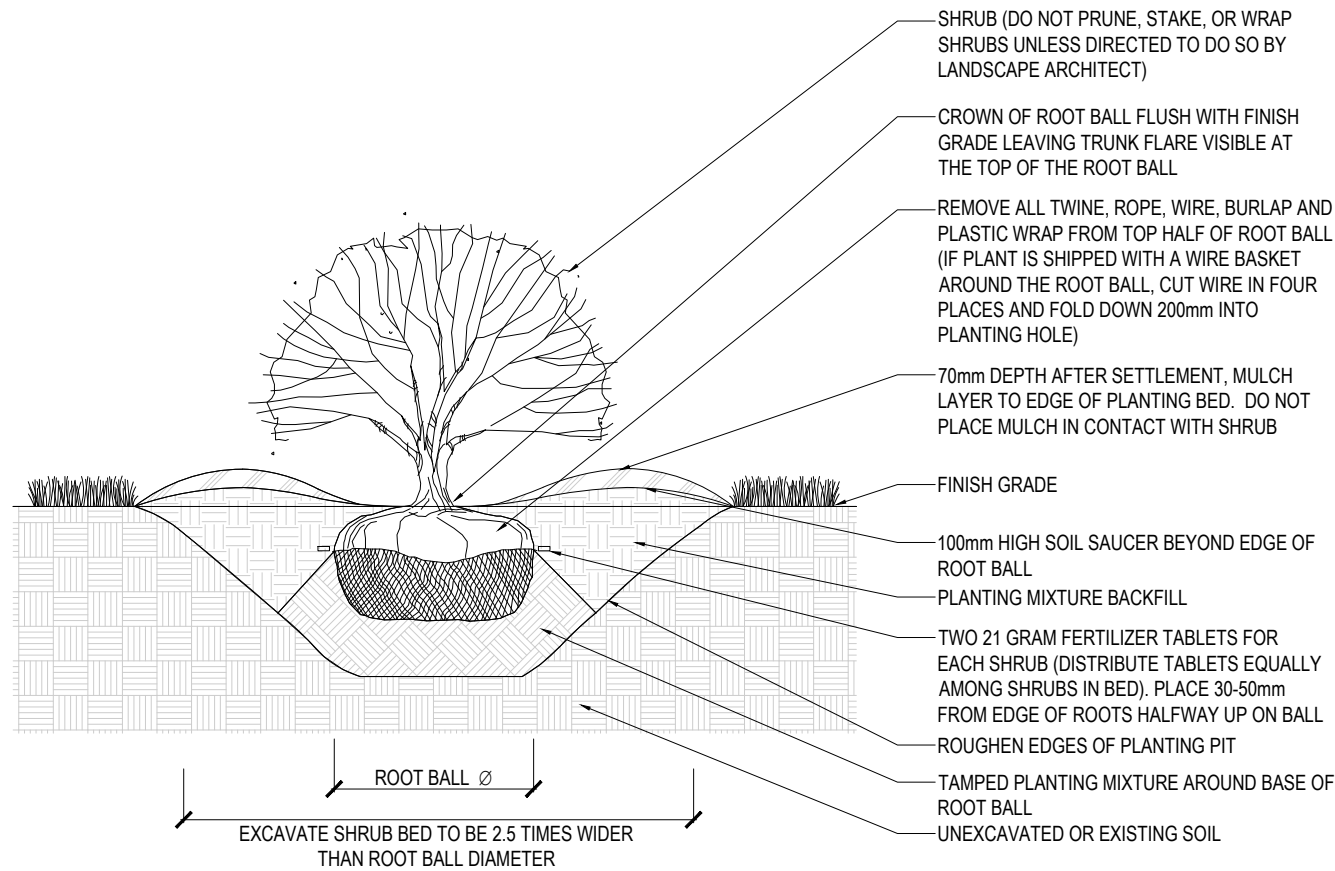

2 B&B SHRUB PLANTING DETAIL
SCALE=NO SCALE

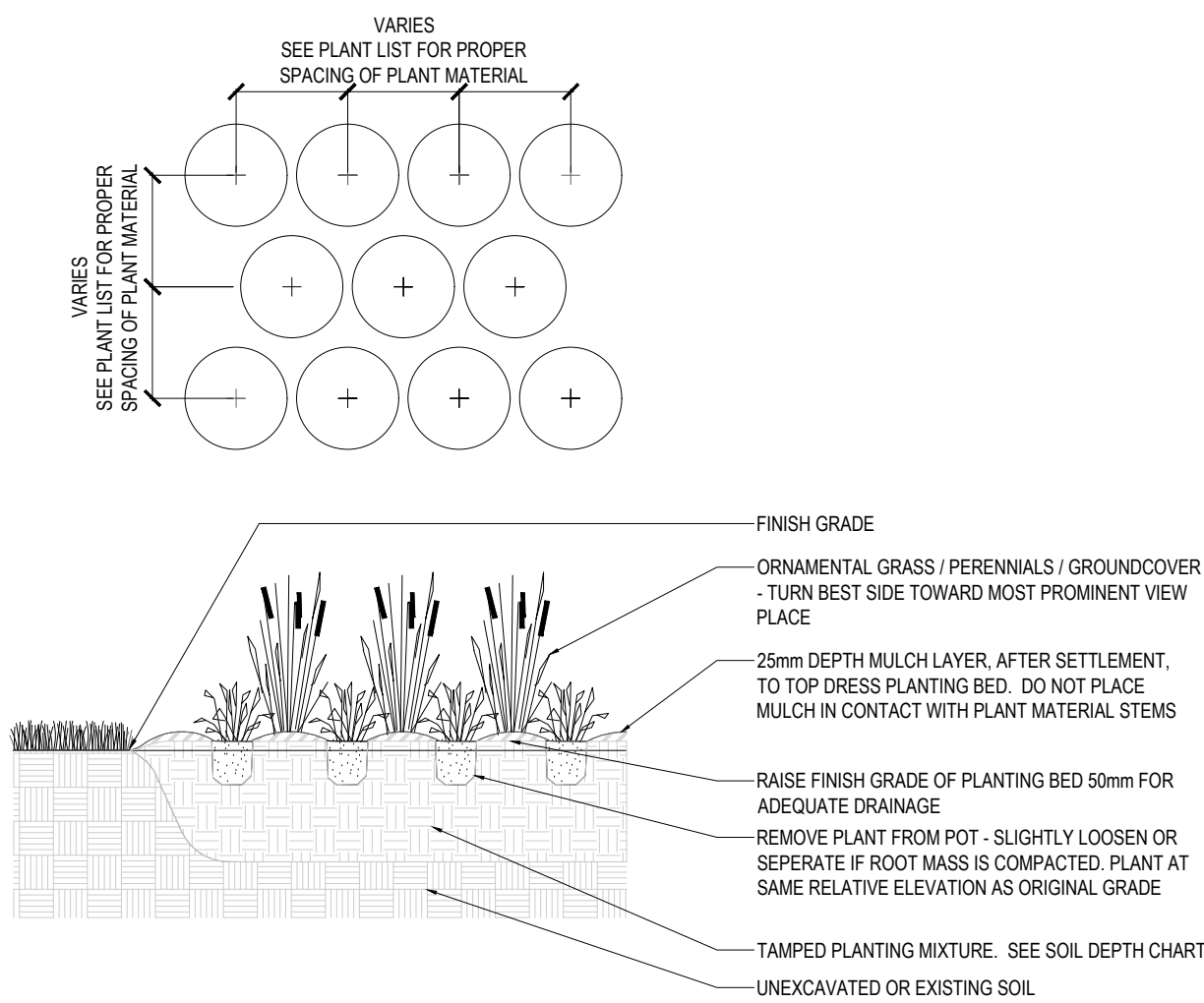

3 GROUND COVER PLANTING DETAIL
NO SCALE

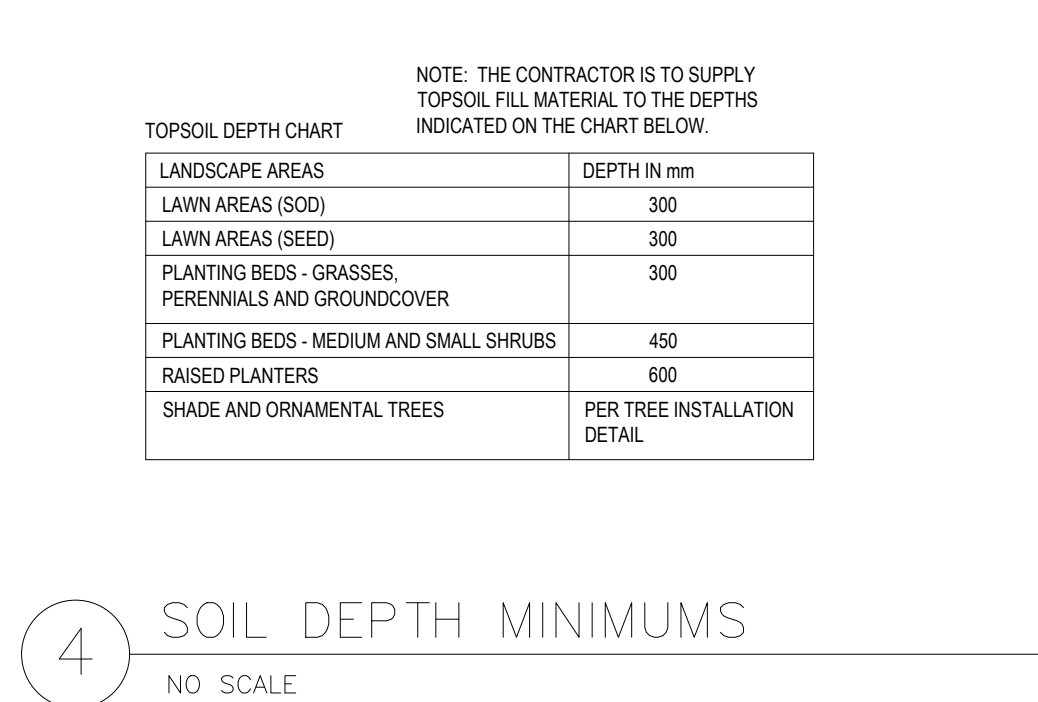

4 SOIL DEPTH MINIMUMS
NO SCALE

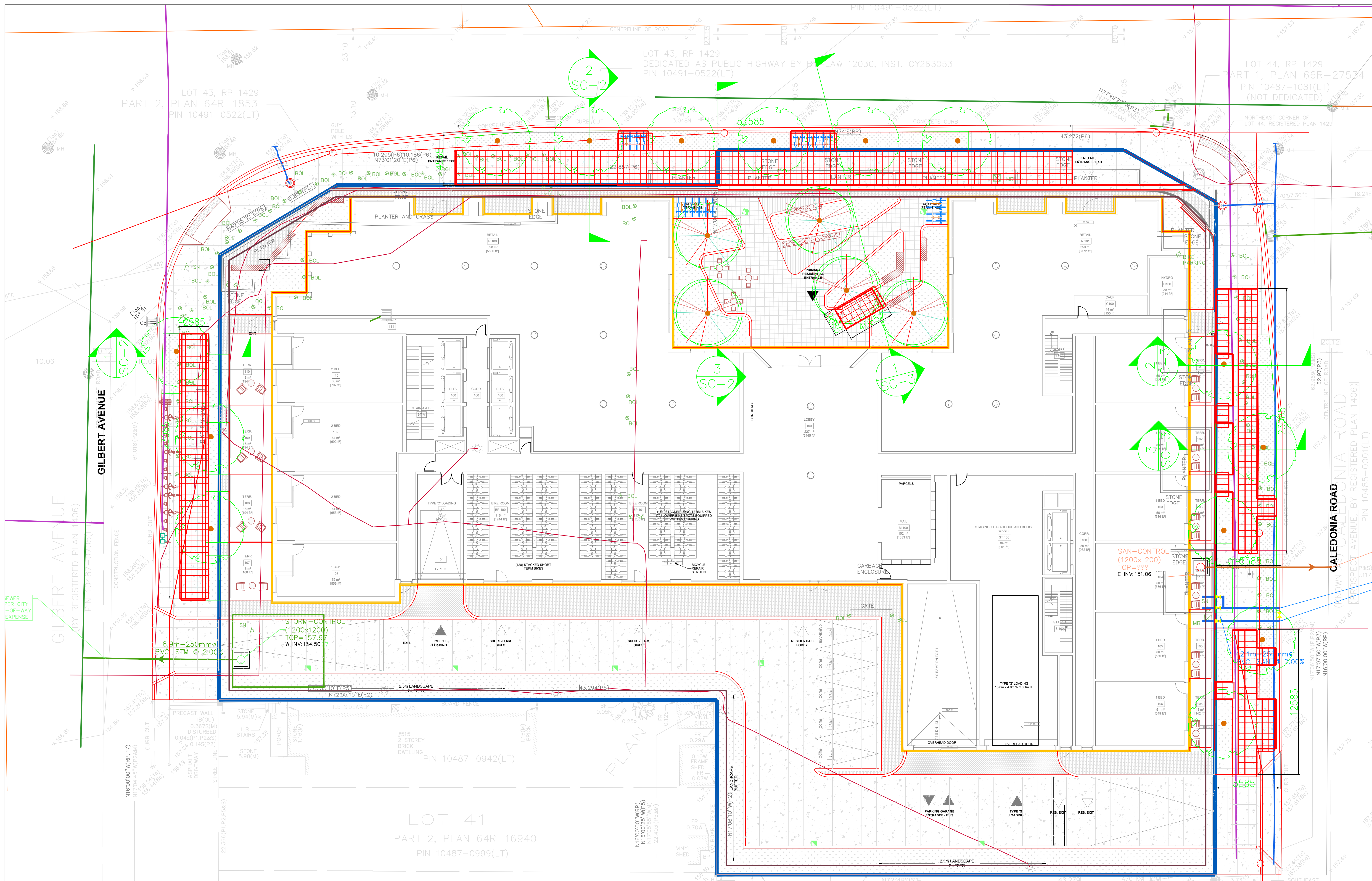

SOIL CELL LAYOUT
SCALE: 1:150

All of the drawings and details will meet the applicable vehicular loading requirement according to the current version of the Canadian Highway Bridge Design Code CSA S6.
Designed to safely support a specified load of :DL-16 kpa LL=14 kpa (Or point load of 87.5 KN whichever provides the worse case)
The design of the sidewalk, the underlying material and soils, shown on landscape plans, are able to withstand vehicular loading (minimum CL-625-ONT) pursuant to the current version of the Canadian Highway Bridge Design Code CSA 6.

2343 EGLINTON AVENUE WEST
2343 EGLINTON AVENUE WEST
STUDIO TLA
CITY OF TORONTO / PROVINCE OF ONTARIO
INSTALLATION INSTRUCTIONS

ENGINEER STAMP #1

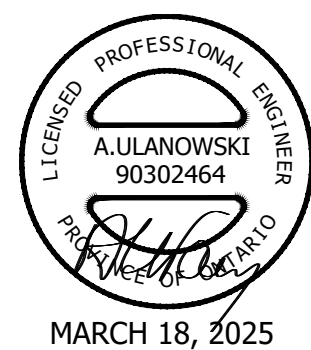

ENGINEER STAMP #2



DATE:
03/17/2025
DRAWN BY:
LF
CHECKED BY:
CM
SHEET NO

SC-1

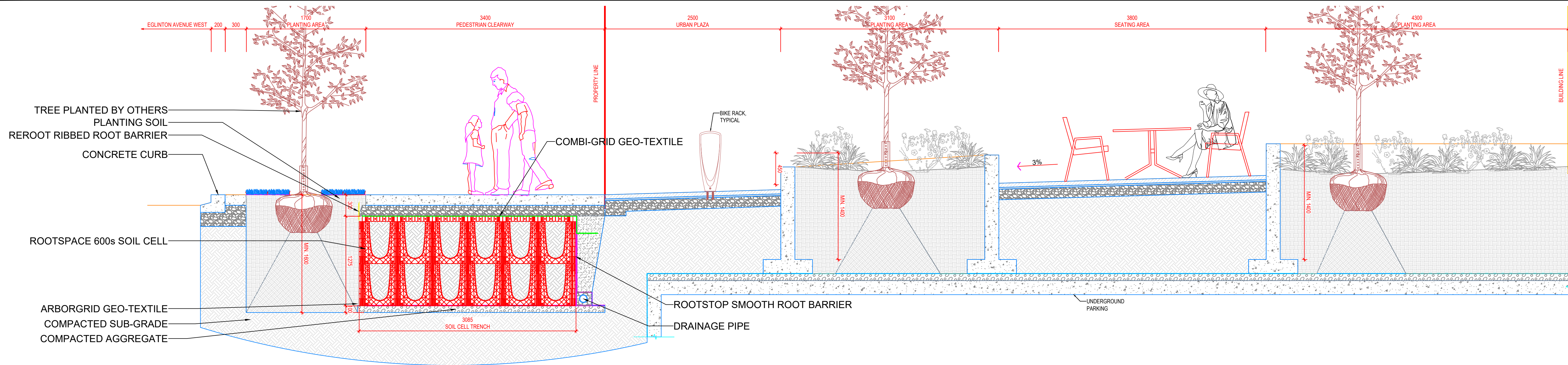

1 LANDSCAPE SOIL CELL SECTION 1
SC-2 SCALE: 1:30

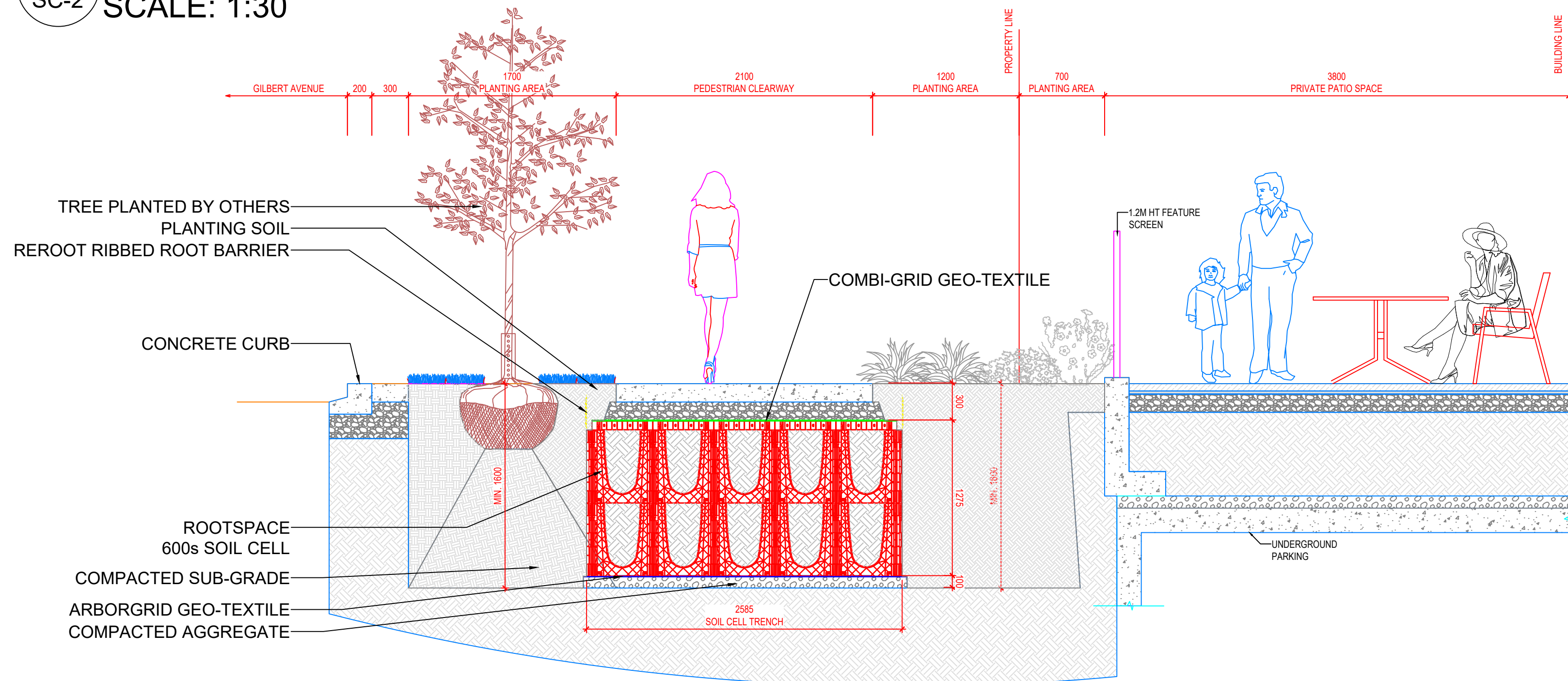

2 LANDSCAPE SOIL CELL SECTION 2
SC-2 SCALE: 1:30

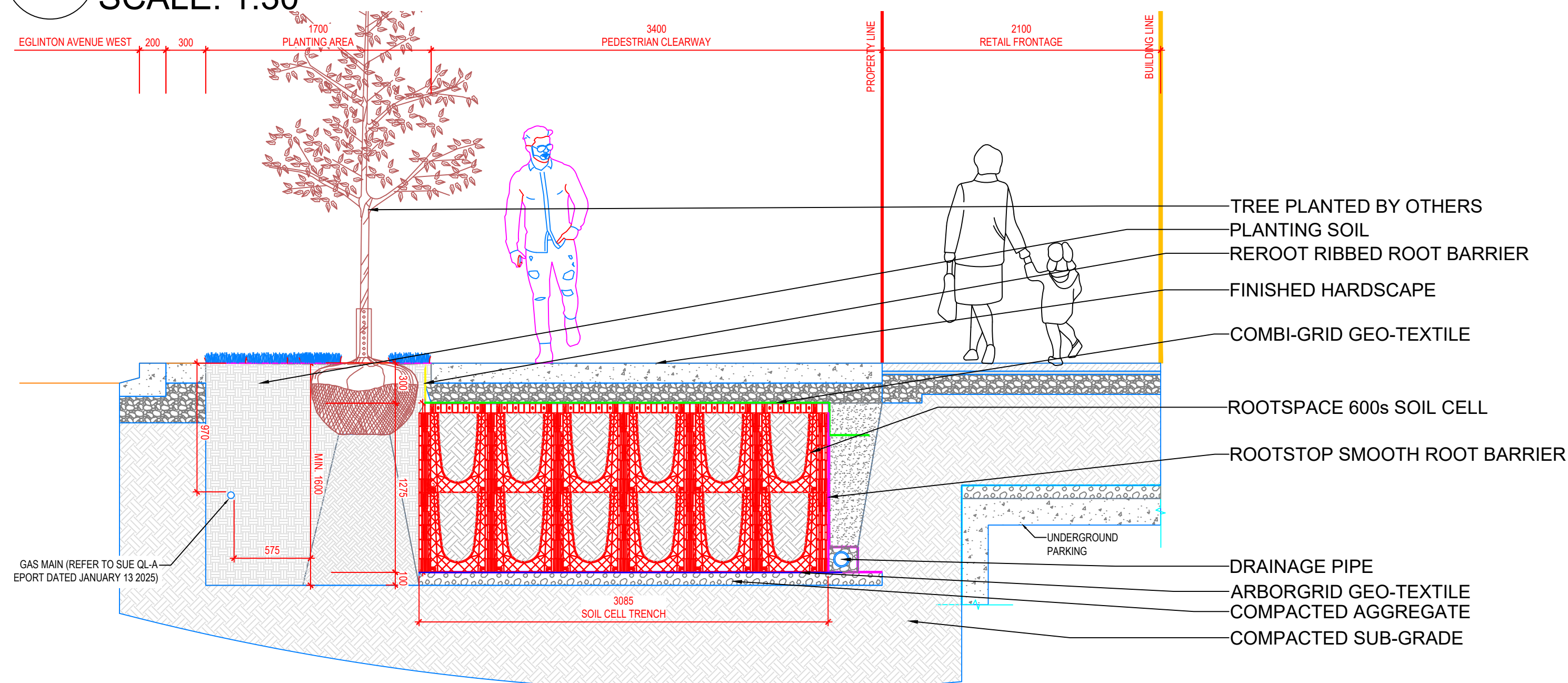

3 LANDSCAPE SOIL CELL SECTION 3
SC-2 SCALE: 1:30

All of the drawings and details will meet the applicable vehicular loading requirement according to the current version of the Canadian Highway Bridge Design Code CSA S6.
Designed to safely support a specified load of :DL-16 kpa LL=14 kpa (Or point load of 87.5 KN whichever provides the worse case)
The design of the sidewalk, the underlying material and soils, shown on landscape plans, are able to withstand vehicular loading (minimum CL-625-ONT) pursuant to the current version of the Canadian Highway Bridge Design Code CSA 6.

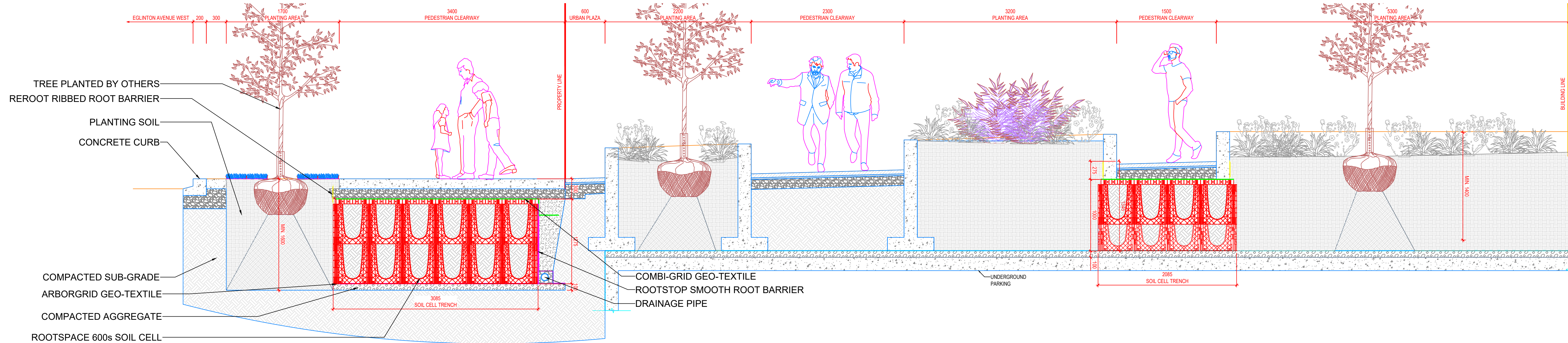

1 LANDSCAPE SOIL CELL SECTION 4
SC-3 SCALE: 1:30

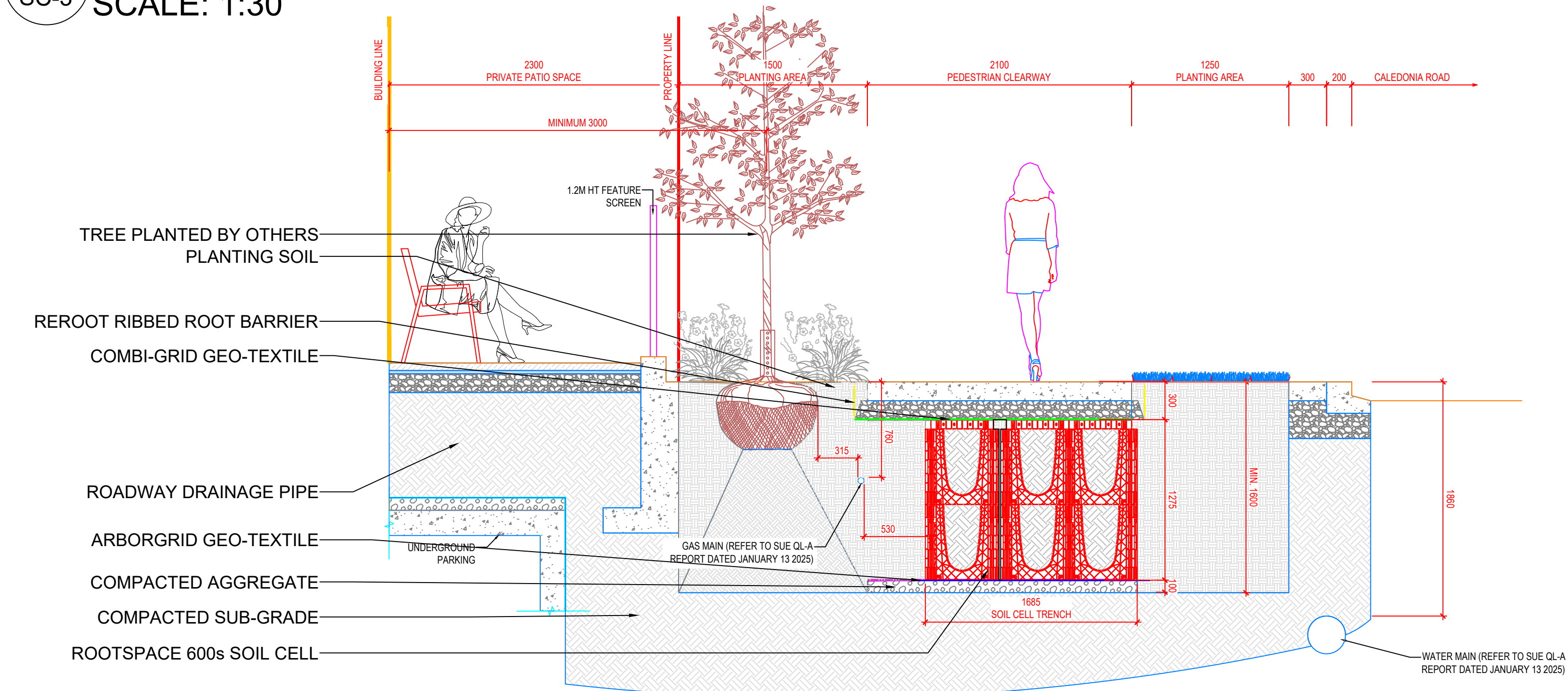

2 LANDSCAPE SOIL CELL SECTION 5
SC-3 SCALE: 1:30

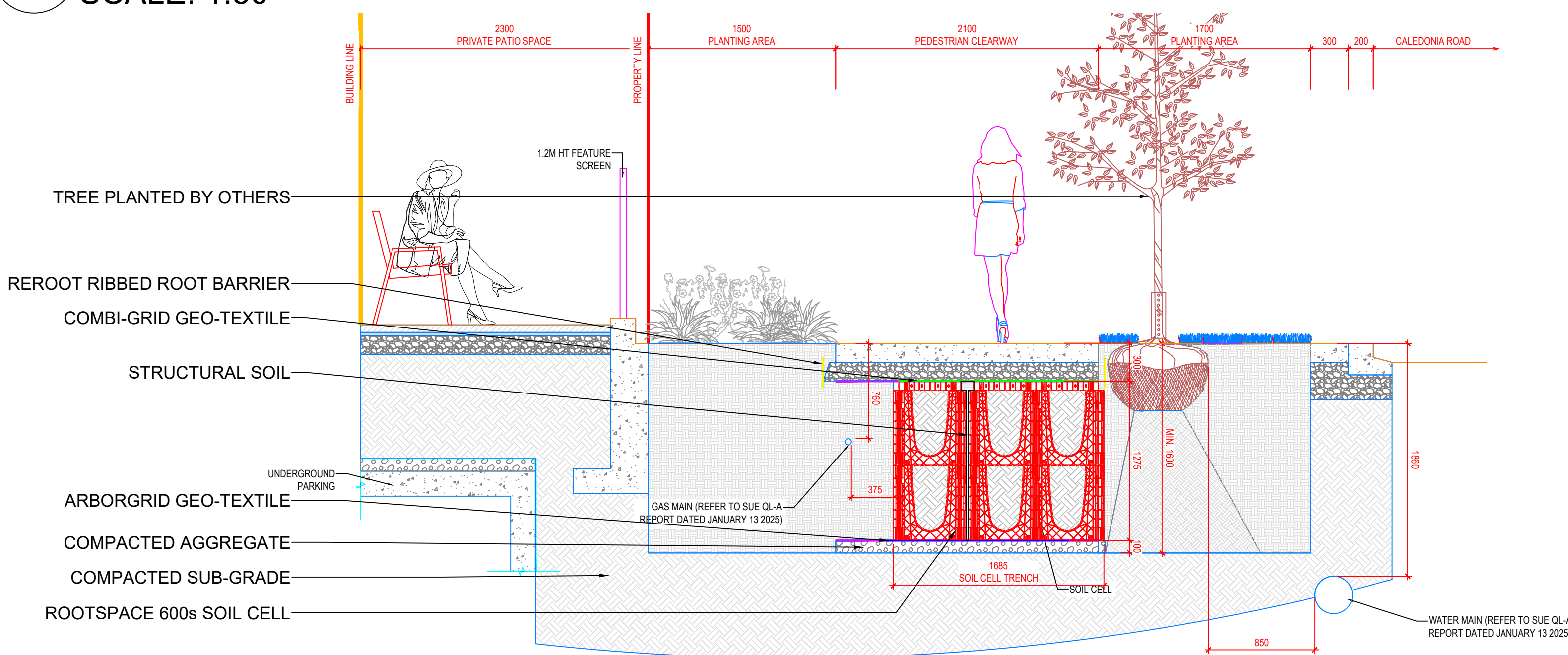

3 LANDSCAPE SOIL CELL SECTION 6
SC-3 SCALE: 1:30

All of the drawings and details will meet the applicable vehicular loading requirement according to the current version of the Canadian Highway Bridge Design Code CSA S6.
Designed to safely support a specified load of :DL-16 kpa LL=14 kpa (Or point load of 87.5 KN whichever provides the worse case)
The design of the sidewalk, the underlying material and soils, shown on landscape plans, are able to withstand vehicular loading (minimum CL-625-ONT) pursuant to the current version of the Canadian Highway Bridge Design Code CSA 6.

ENGINEER STAMP #1

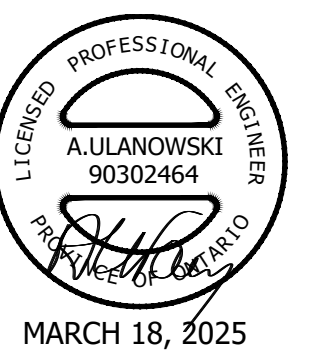

ENGINEER STAMP #2

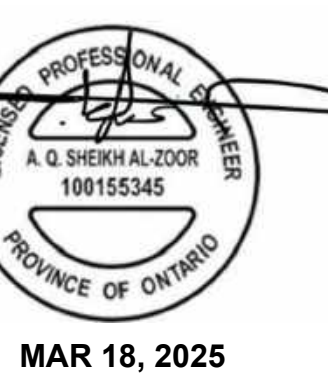

DATE:
03/17/2025

DRAWN BY:
LF

CHECKED BY:
CM

SHEET NO

SC-3